



SHOWER LINE

IBS SHOWERLINE is a popular wet wall lining bringing together the strength and durability of an aluminium composite panel with the smooth and stylish coating of a curtain coated paint finish.



SHOWER LINE

WET WALL ECONOMY & STYLE

IBS SHOWERLINE FOR ALL WET WALL LINING REQUIREMENTS.

When installed in accordance with the easy to follow instructions in this brochure IBS SHOWERLINE will keep that wet or utility area looking great for many years to come.

- Bathrooms
- Toilets
- Laundries
- Kitchen work areas
- Kitchen ceilings
- Behind fridges
- Lunchrooms
- Lunch bars
- Any food preparation area
- Lining public or Work toilet areas
- Prefinished glossy ceilings in any wet area
- Any other area where easy clean up is required

AVAILABLE IN
White

**AVAILABLE IN
TWO SHEET SIZES**

2400x1200

2400x900

Thickness 4.75mm

IBS SHOWERLINE INSTALLATION GUIDE

Step 1 Planning

It is important to take sometime to plan your project. Make sure that you have all the tools as listed on the bottom of the opposite page. Think about the best size to use on each wall to make the joins fall in the best place.

Step 2 Preparations

Make sure that the surface you are installing the IBS SHOWERLINE on is solid, dry and clean. IBS SHOWERLINE can be glued directly onto your studs or may be glued onto an existing substrate such as fibre cement board. Clean the area that you are fixing your IBS SHOWERLINE to with Holdfast 696 surface activator.

Step 3 Cutting

Remember the rule, measure twice and cut once. Use a fine-toothed saw and cut panels FACE UP. Keep the angle of the saw less than thirty degrees to the sheet. After cutting out your sheets to the correct size, place them on the wall to make sure prior to applying gluing. We recommend using Holdfast Fix All 220 Sealant and Gator Foam Tape.

Step 4 Installing IBS SHOWERLINE

Ensure that you remove the plastic protective layer on the back side prior to fixing to the wall. Apply the Gator Foam Tape to the frame followed by a continuous bead of Fix All 220 MS Sealant using a Gorilla Pro Gun. Gently press the Showerline panel against adhesive to join. Allow 24 hours for full cure. If you are installing in a shower situation make sure you follow the following diagrams. Use FULLERS® 770 SANITARY SILICONE at the bottom and behind the drip edge.

Step 5 Cleaning

A cloth lubricated with a non-abrasive detergent allows easy removal of grime. **Note:** Abrasive cleaners should not be used for this product.

Step 6 Celebrate

Now that you have completed your project it's time to celebrate and enjoy your new area. Be sure to show your friends and family and tell everyone just how good and easy IBS SHOWERLINE is to install.

Wall to tile shower tray

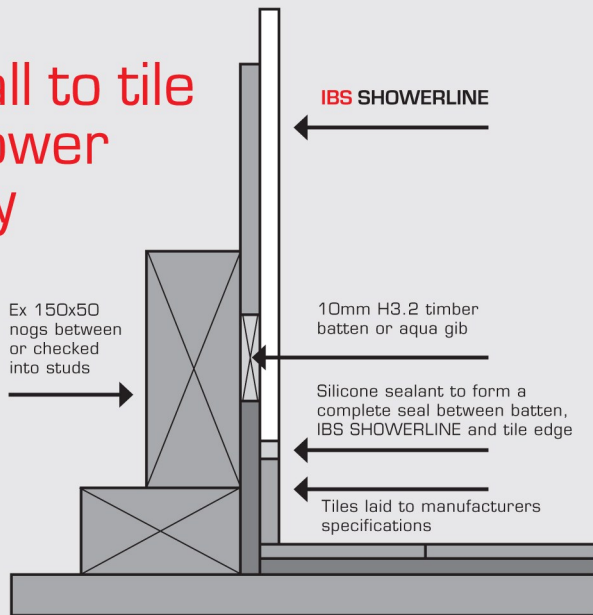

Wall to acrylic tray

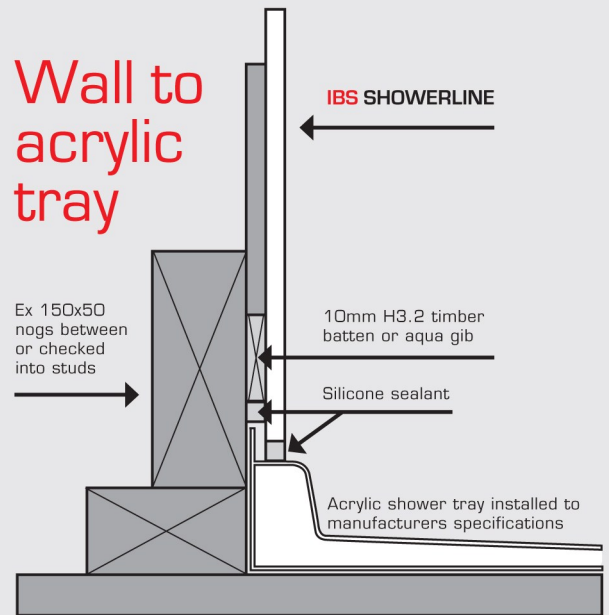

Wall to steel shower tray

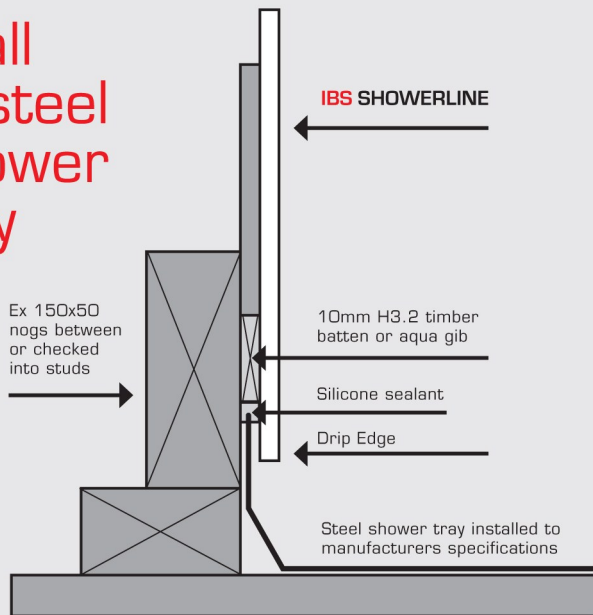

Wall to bath edge

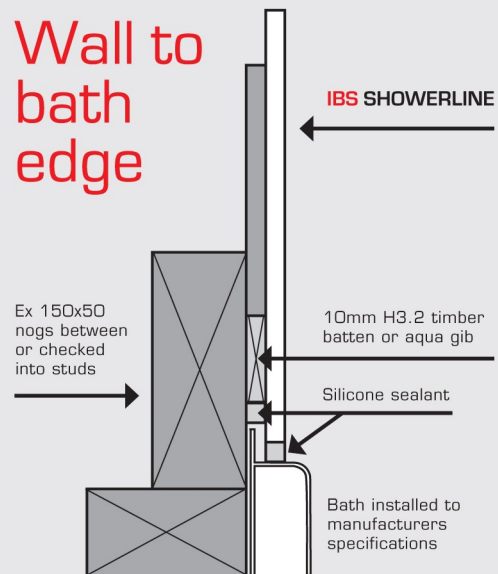

Important safety message

When using IBS Showerline ACP in a situation where there is any kind of power socket or switch you will need to ensure that you earth bond each and every panel using the following method.

There are 2 options when earthing Showerline ACP depending on the type of mouldings that you are using.

1. When using plastic or silicon mouldings you would need to earth each sheet that could possibly come into contact with power. Basically if there are any wires behind the sheet on either side of the wall or if there is a power socket in the sheet itself, you will need to earth it using a crimp lug. The crimp lug will be easily hidden behind the skirting, scotias or just to the side of the penetration for the power socket, making sure that the cover plate hides it. A crimp lug is a simple screw connector that allows you to connect a bonding wire which will feed back to earth to the board itself and will earth both the face side and the backside at the same time.

2. When using aluminum mouldings you may only need to use one crimp lug for each area where all the boards are forming one circuit. You must confirm this with an electrician on-site.

HOW TO FIX IBS SHOWERLINE PANELS

Guarantee a safe secure bond!

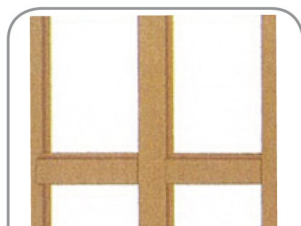

STEP 1
Clean surface by wiping
with Holdfast® 696
Surface Activator.

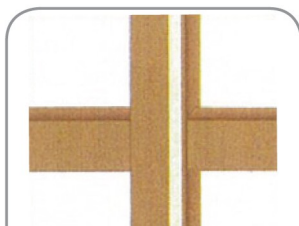

STEP 2
Apply Gator Foam®
Tape to frame

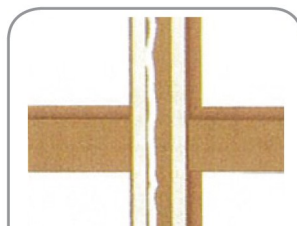

STEP 3
Apply continuous bead of
Fix All® 220 MS Sealant
using a Gorilla® Pro Gun

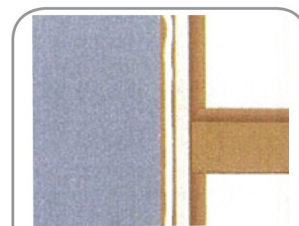

STEP 4
Gently press the Showerline
panel against adhesive to join.
Allow 24 hours for full cure

...what you need!



Why Fix All® 220 Sealant?

Fix All® 220 Sealant is a high performance MS sealant,
with superior flexibility. Guaranteed to stick!



Tools and materials for a professional finish

Table Use this to plan out your job (prior to starting guys) and then place a towel over the top and use it as a cutting table (don't cut the table!)

Pencil To mark before cutting and gluing your panel.

Carpenters Square To ensure that you rule straight lines before you cut.

Tape Measure Remember the golden rule...Measure twice, cut once!

Drill & Hole Cutting Bit Use this to cut holes for your taps and shower fittings.

Glue Gun To apply the silicon and panel glue

Wall Board Adhesive Recommend Holdfast Fix All 220 MS Sealant and Gator Foam Tape.

Spirit Level To ensure that the sheets line up correctly. It is important that all sheets are installed level.

Silicon Use only 100% silicon and ensure that it is designed for use in a Bathroom or Kitchen.

We recommend FULLERS® 770 SANITARY SILICONE

Masking Tape To protect your panels and ensure a clean finish when applying silicon.

Fine Toothed Saw Cut the panels FACE UP. Keep angle of saw less than 30 degrees to the sheet.