



International

PRÎMACTUTM

Features



PRIMA CTU™

Ceramic Tile Underlay

Ideal ceramic tiles laying substrate Ceramic Tile Underlay

PRIMA CTU™ is a premium quality autoclaved cellulose fibre reinforced cement board manufactured from portland cement, top grade quality pulp from New Zealand, finely ground sand and water by Hume Cemboard Industries Sdn Bhd, an MS ISO 9001:2000 accredited company.

PRIMA CTU™ has superior fire performance and dimensional stability, which makes it an ideal substrate for ceramic tiles in wet and dry areas.

Manufactured with a pre-marked nailing pattern, sheets can be easily laid on existing timber flooring with minimal surface preparation.

Product Features & Benefits

- Water Resistant
- Termite Resistant
- Fire Resistant
- Fungus Resistant
- Impact Resistant
- Good Workability
- Structurally Strong
- Reduces tile movements.
- Flat surface for smooth ceramic tile finishing.
- Pre-printed fastener points for ease of installation.
- Square cut edges for neat sheet jointing.
- Fibre cement superiority with lasting durability.
- Simple and easy installation.
- No stripping of old floor boards.
- Applicable in wet and dry areas.
- Less cutting and joining for large/wider areas.

Standard Sizes

PRIMA CTU™ standard thickness is 6.0mm.
Its mass at EMC is approximately 8.8kg/m²

Thickness (mm)	Width (mm)	Length (mm)
6.0	900	1800
	1200	1800

Note: Other sizes are available on special order and may be subject to special conditions.



Handling & Finishing

PRIMA CTU™ should be overlaid with ceramic, mosaic or marble tiles. Use a compatible flexible tile adhesive. Ensure the sheet surface is free from dust or other contaminants prior to tiling. Refer to your tile adhesive manufacturer for more details.

Underfloor Preparation Ventilation

Ensure that the underside of the existing floor is adequately ventilated and free from dampness.

Existing Floorboards

Check and replace any damaged floorboards and firmly renail any loose boards. The surface must be reasonably flat. Rough-sand any undulation prior to fixing the ceramic tile underlay

Installation Steps

Handling & Finishing

Step 1

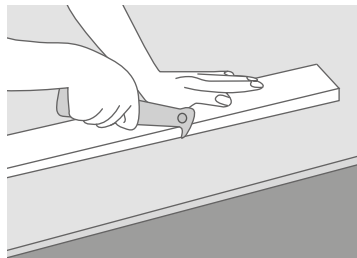

Cut the **PRIMA CTU™** using a "score and snap" knife. Use a straight edge as a guide while scoring a minimum of 1/3 of sheet thickness.

Step 2

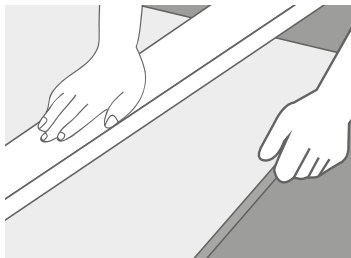

Hold the sheet firmly near the cut, while snapping the off-cut upward to break.

Step 3

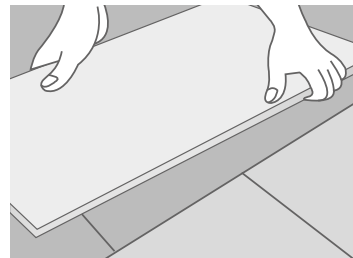

Lay **PRIMA CTU™** across the floorboard direction in a staggered (brick) pattern. Sheet joints must not coincide with floorboard joints (provide a minimum of 100mm offset). Allow a minimum of 3mm gap between sheet edges and walls.

Step 4

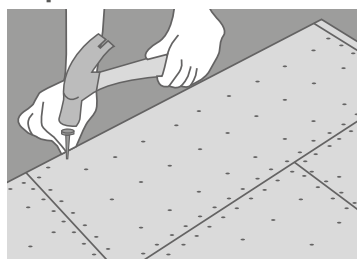

Fasten **PRIMA CTU™** from centre and working outwards using the pre-printed nailing pattern. Use 25mm x 2.5mm underlay nails. Drive nails flush with sheet surface.

Step 5



Apply tile adhesive onto **PRIMA CTU™** using a notched trowel. Refer to adhesive manufacturer's instructions.

Step 6



Lay ceramic tiles in accordance with tile manufacturer's recommendations.

Sheet Fixing Illustrations



PRIMA CTU™ can be fixed directly to existing timber, particleboard or plywood floor. Ensure that the existing floorboard is flat and in good condition prior to fixing the underlay sheet. Fasten underlay sheets at the pre-marked fixing positions. Underlay sheets should be laid in staggered or brick pattern.

Sheet Layout

PRIMA CTU™ sheets should be laid in a staggered or brick pattern, across the direction of floorboards. Sheet joints must not coincide with floorboard joints as shown in Figure 1.

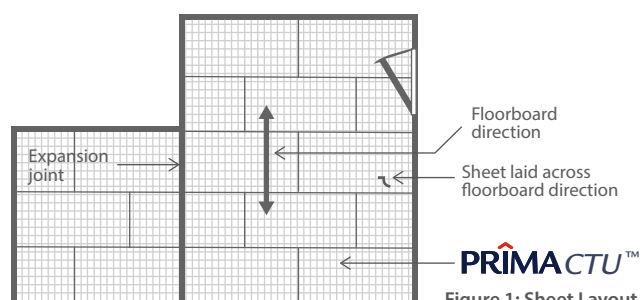

Figure 1: Sheet Layout

Perimeter Expansion Gap

Leave a 3mm gap between sheet edges and wall at the wall-to-floor junction as shown in Figure 2.

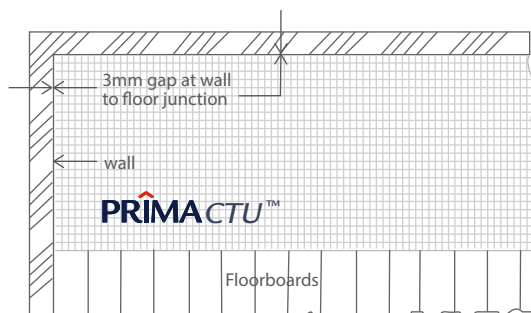

Figure 2: Perimeter Expansion Gap

Fastener Specification

Use 25mm x 2.5mmØ annular threaded underlay nails. Nail fixing locations must be as the following:

- 12mm minimum from sheet edge
- 50mm minimum from corner
- 75mm maximum centres at perimeter
- 150mm maximum centres elsewhere

Drive nail heads flush with the underlay sheet surface. Commence nailing from the sheet centre and work outwards towards the sides and ends of sheet. Refer to Figure 3.

Note: For fixing to particleboard or plywood floor, apply wallboard adhesive to the rear of sheet with a 3mm notched trowel in addition to nail fixing as specified above.

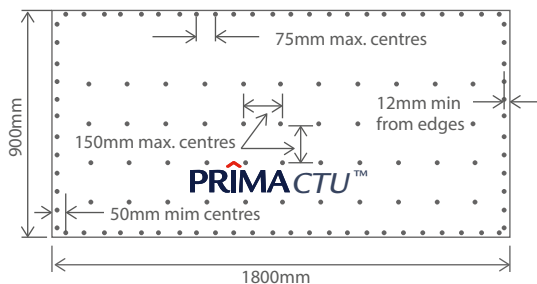

Figure 3: Fixing Locations

Expansion Joints

Expansion joints must be provided at 5.0m maximum centres and must always coincide with the structural break joints of the existing floor structure. Refer to Figure 4.

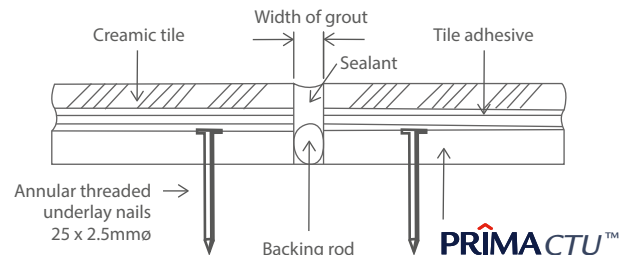

Figure 4: Detail at Expansion Joint

Tile Adhesive & Grout

Use only flexible tile adhesive which comply to AS 2358 - Adhesive for fixing ceramic tiles. Refer to tile adhesive manufacturer for recommendations. Grouting material must be fully compressible.

Tiling

Tiles should be laid in accordance with acceptable tile laying practice. Provide a minimum of 2mm to 3mm gap between each tile.

AS/NZS
2908.2

ASTM
C1186

Fire Resistance
AS 1530.3

Termite Resistance -
tested by CSIRO



CERTIFIED TO ISO 9001:2008
CERT. NO. : AR0430



CERTIFIED TO ISO 14001:2004
CERT. NO. : ER0642



Termite Resistant



Fire Resistant



Water Resistant



Weather Resistant



Environmentally
Friendly



Superior Paint
Adhesion



High Workability



Aesthetically
Pleasing



50 Years
Durability

WARRANTY

Hume Cemboard Industries Sdn Bhd ("the Company") warrants that it will at all times ensure that the products referred to herein ("the Products") shall be supplied by it to the purchaser free of any manufacturing defects and defective materials used in their manufacture.

In the event and if contrary to this assertion the Products prove to be defective, whether as a result of manufacturing defects or arising from the Company's use of defective materials, the Company will supply replacement Products. The Company shall, however, have the option and may choose to reimburse the purchaser the purchase price of the Products instead. The Company shall not be liable for any economic or consequential losses arising from any use of defective Products.

This warranty shall be void unless the purchaser has, in its handling and installation of the Products, complied with the recommendations contained in this brochure and other good building practices expected of a reasonable purchaser.

ADVISORY NOTE

Successful installations of Hume Cemboard Industries Sdn Bhd's Products depend on a large number of factors that are outside of the scope of this brochure. Particular design, detail, construction requirements and workmanship are beyond the control of the Company. As such, Hume Cemboard Industries Sdn Bhd's warranty does not extend to non-usability of Products or damage to Products arising from poor or defective designs or systems or poor quality of workmanship in the installation of Products.



For more information, please contact us at:

Hume Cemboard Industries

A Member of the Hong Leong Group

No. 12 Jalan Tandang, 46050 Petaling Jaya, Selangor, Malaysia.

Malaysia Sales

Tel: + 603 7625 9999 Fax: +603 7625 7822 Email: sales@humecemboard.com.my

Oversea Sales

Tel: + 603 7625 3880 Fax: +603 7625 3990 Email: exportHCl@humecemboard.com.my

www.primafibrement.com